

# SIZE 34 STEPPER MOTOR DATA

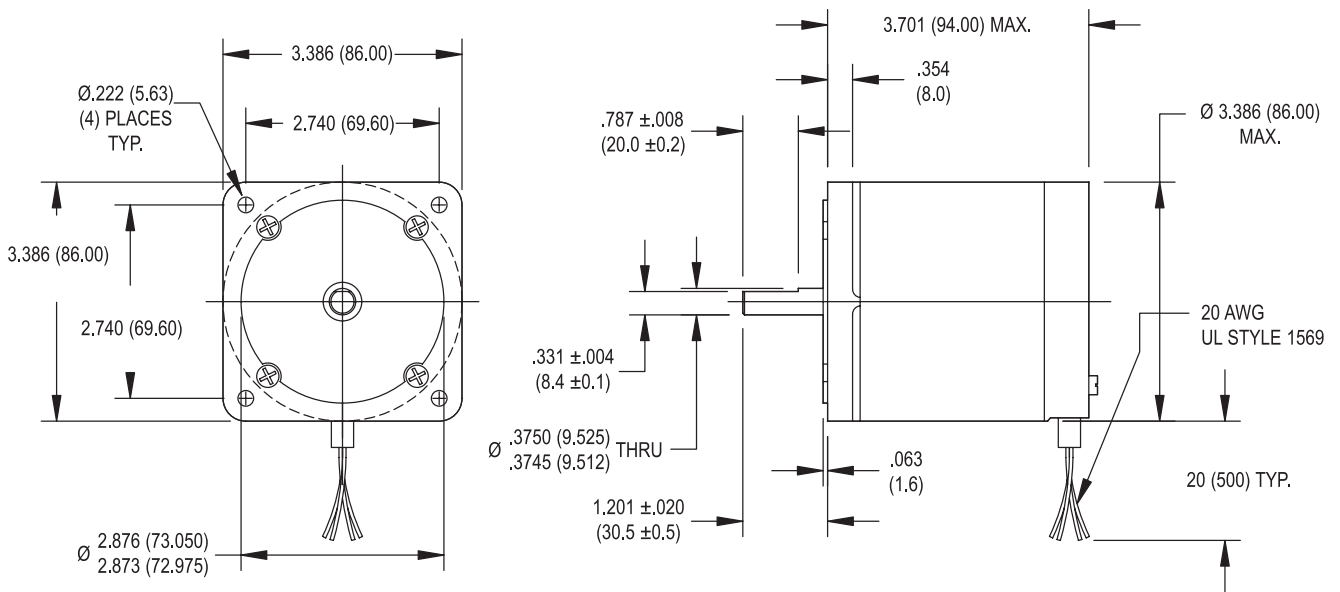

| Specification           | Units                                  | HN 200 3438 |      |
|-------------------------|--|-------------|------|
|                         |  | 0280        | 0430 |
| Rated Phase Current     | A                                      | 2.80        | 4.30 |
| Phase Resistance        | $\Omega$                               | 1.7         | 0.75 |
| Phase Inductance        | mH                                     | 7.7         | 3.5  |
| Holding Torque Unipolar | oz-in                                  | 538         | 538  |
|                         | Ncm                                    | 380         | 380  |
| Holding Torque Bipolar  | oz-in                                  | 680         | 680  |
|                         | Ncm                                    | 480         | 480  |
| Detent Torque           | oz-in                                  | 18          | 18   |
|                         | Ncm                                    | 13          | 13   |
| Rotor Inertia           | oz-in-s <sup>2</sup> x10 <sup>-4</sup> | 170         | 170  |
|                         | g-cm <sup>2</sup>                      | 1200        | 1200 |
| Motor Weight (Mass)     | lb                                     | 5.3         | 5.3  |
|                         | kg                                     | 2.4         | 2.4  |
| Maximum Voltage         | V                                      | 90          | 90   |
| Std. No. of Leads       | —                                      | 8           | 8    |

Available through the MotionExpress program.

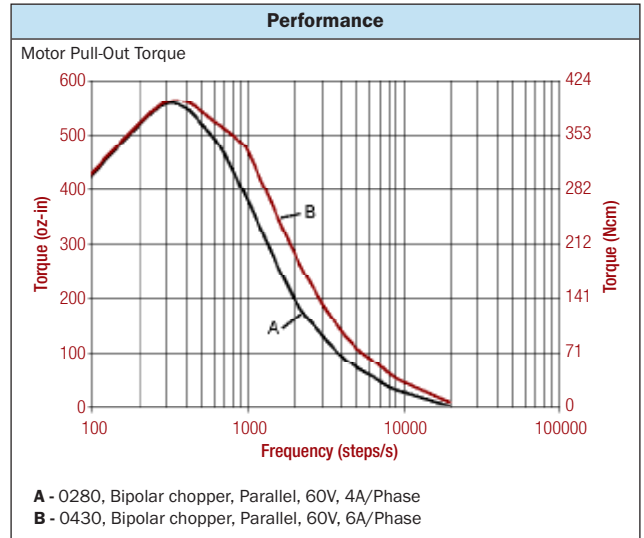

- ### Standard Features
- Step angle: 1.8°
  - Step angle accuracy: 5%
  - Insulation class: B (130 °C)
  - NEMA 34 mounting configuration
  - Neodymium magnets
  - Additional windings and customization options available
  - CE approved

- ### Complementary Products
- Gearboxes
  - Encoders

